



Fun Name. Serious Fence.

NEWPORT VINYL PICKET GATE (42" W X 31"H)

ASSEMBLY INSTRUCTIONS ZP19004

60 MIN

Approximate assembly time

*Want to see a video on how to
assemble this product?*

Scan the QR code

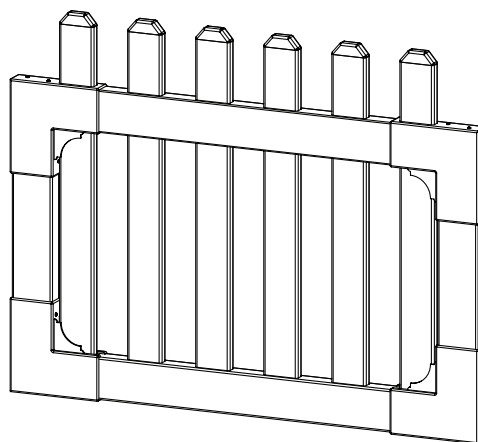

GENERAL INFORMATION

MISSING OR DAMAGED PARTS?



► **Visit Our Website**
so we can help you right away!
parts.nychbrands.com

* You can also reach us via phone or email.

Hours of Operation - **Weekdays 9am-5pm EST**

To better help you, **please have the following**

- Your product number (**ZP19004**)
- Your affected part letters
- Your original product box

NEED ASSEMBLY HELP?

If you are having problems with assembly or installation of this product,
please contact at:

📞 **704-892-5222 / 877-234-6196** ✉ **hmmm@wambamfence.com**

NEED TO RETURN?

If for some reason you need to return this product, please allow us to help resolve your issues first. If you still decide to return the product, **you will need to initiate the return from the company you originally purchased from.**

GENERAL INFORMATION

1. Read over fence instructions first.

Your gate and fence will work better together if you first take the time to read and understand your fence.

2. Pre-Assemble the gate frame.

Please do not screw the gate frame together until you have temporarily assembled the gate frame. In other words, do a dry run first. This will ensure:

1. That you have everything necessary to complete the gate.
2. That you will have assembled the gate frame in the correct order.
3. All of the pieces fit and function properly.
4. The gate height and width are similar to the measurements shown on page four.

It's easier to troubleshoot when things are not screwed together. After you assemble your gate correctly, please disassemble as necessary, and use the 1¼" self-drilling stainless steel screws to permanently assemble the gate.

3. Install your gate posts before your fence posts.

Your fence panels will be more forgiving for a custom fit than your gate. Position and install your gate posts before you do anything else.

4. Do not hang your gate system off a single non-supported post.

Your gate will perform better and last longer if your hinge post is connected to a panel of fence that is connected to another post. This way, the weight strain will be transferred onto two posts versus just one. Installing fence panels on both sides of your gate is ideal in all situations. If this is not possible because of space restrictions, please contact us for alternative solutions.

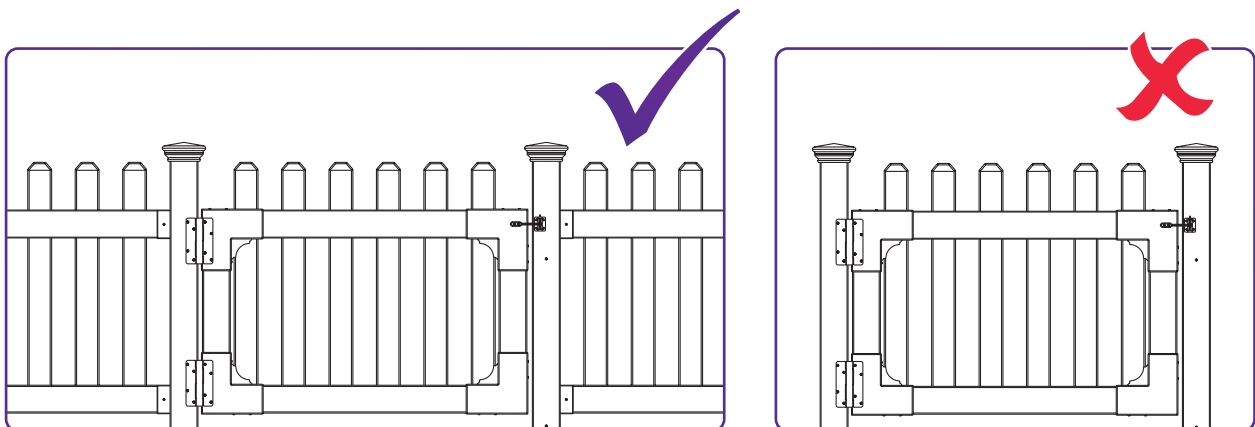

DETAILED PRODUCT DIMENSIONS AND SPECIFICATIONS

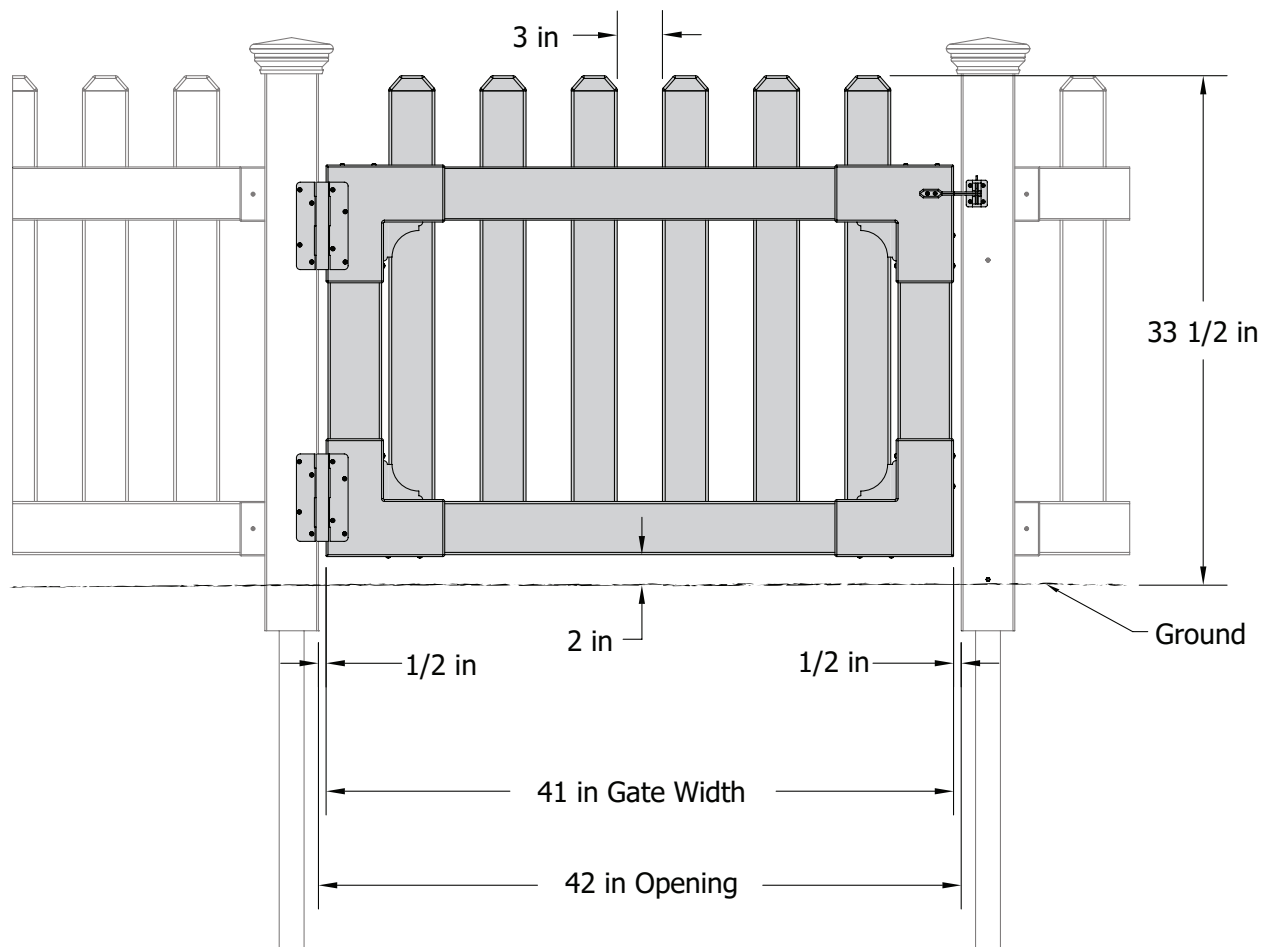

LAY OUT MATERIALS

► Tools required for a smoother installation experience.

► Drill



► Wood Blocks
(Optional)

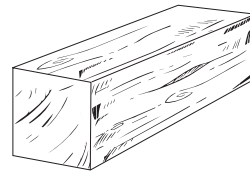

A ►

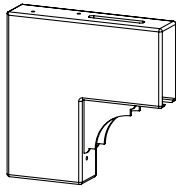

Top Gate Bracket (2)

B ►

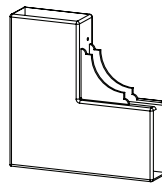

Bottom Gate Bracket (2)

C ►



Vertical Stile (2)
 $1\frac{1}{2}" \times 3\frac{1}{2}" \times 18\frac{1}{8}"$

D ►



Picket (6)
 $\frac{7}{8}" \times 3" \times 29\frac{3}{4}"$

E ►

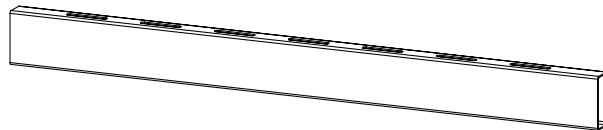

Top Rail (1)
 $1\frac{1}{2}" \times 3\frac{1}{2}" \times 40\frac{3}{4}"$

F ►

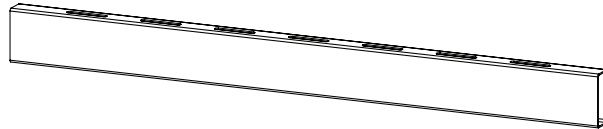

Bottom Rail (1)
 $1\frac{1}{2}" \times 3\frac{1}{2}" \times 40\frac{3}{4}"$

LAY OUT MATERIALS

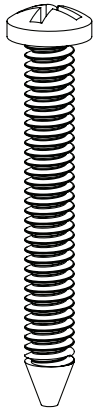
G ▶

1 1/4" White Self-Drilling
Stainless Steel Screw (24)

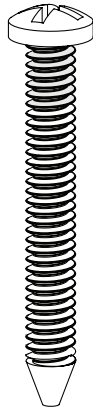
H ▶

1 1/4" Black Self-Drilling
Stainless Steel Screw (38)

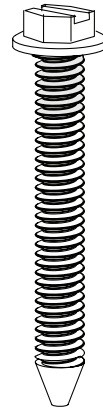
I ▶

1 1/4" Black Self-Drilling Hex
Head Steel Screw (4)

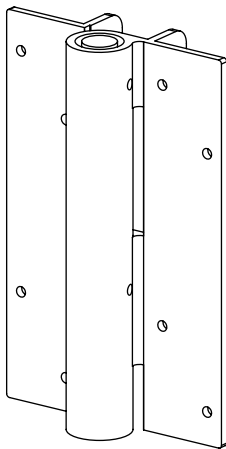
J ▶

Gate Hinge (2)

K ▶

Latch Finger (1)

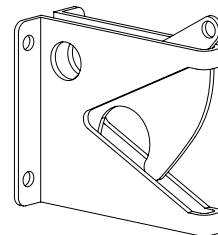
L ▶

Latch Catch (1)

ASSEMBLE THE GATE FRAME

STEP 1

- Insert the Bottom Rail (F) into the first Bottom Gate Bracket (B) as illustrated.

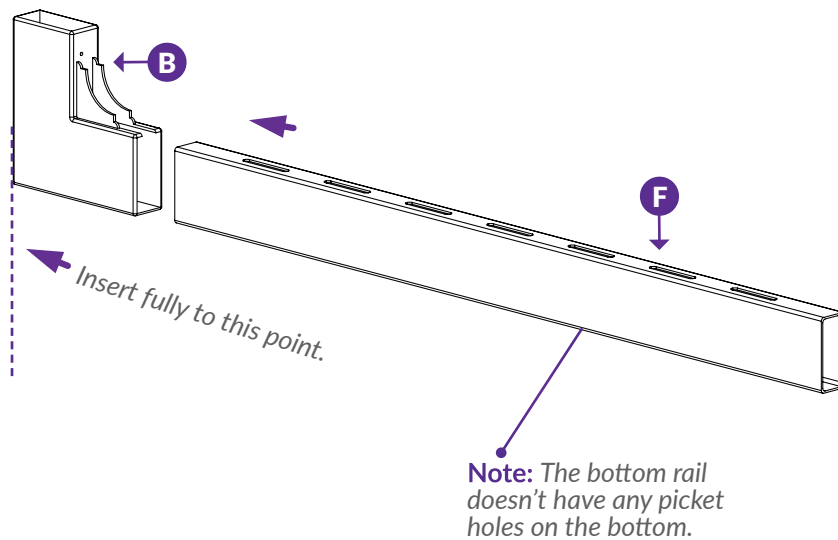

STEP 2

- Insert the bottom rail into the opposite bottom gate bracket as illustrated.

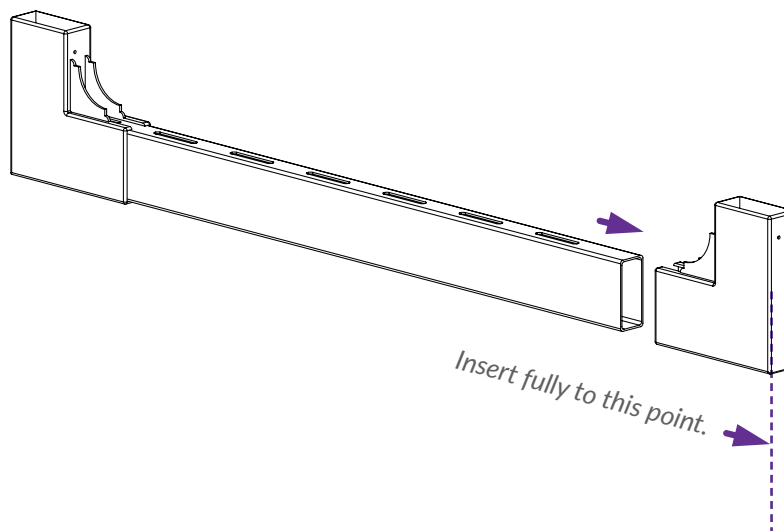

STEP 3 ▶

▶ Insert Vertical Stiles (C). They will bottom out against bottom rail.

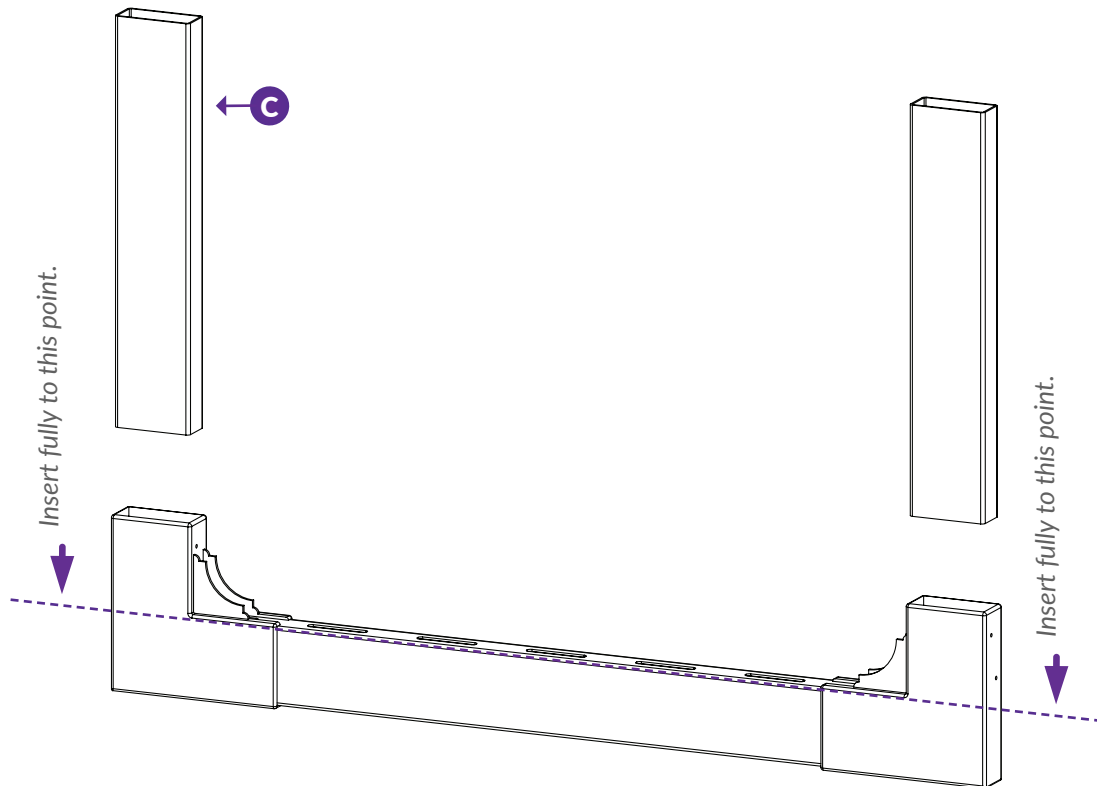

Assembled gate frame bottom.

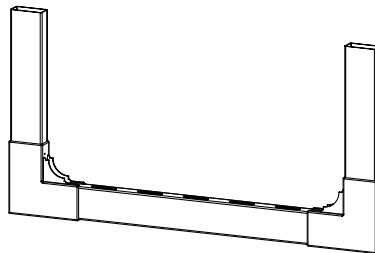

STEP 4 ▶

- ▶ Insert the Bottom Rail (F) into the first Bottom Gate Bracket (B) as illustrated.

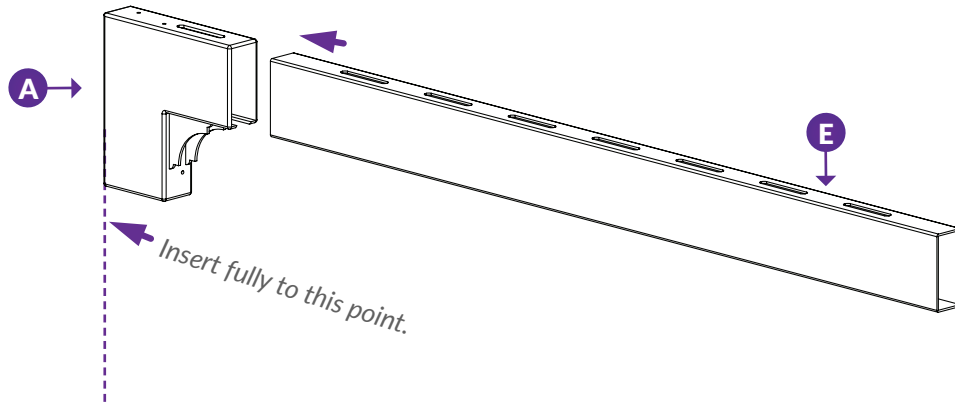
**STEP 5** ▶

- ▶ Insert the bottom rail into the opposite bottom gate bracket as illustrated.

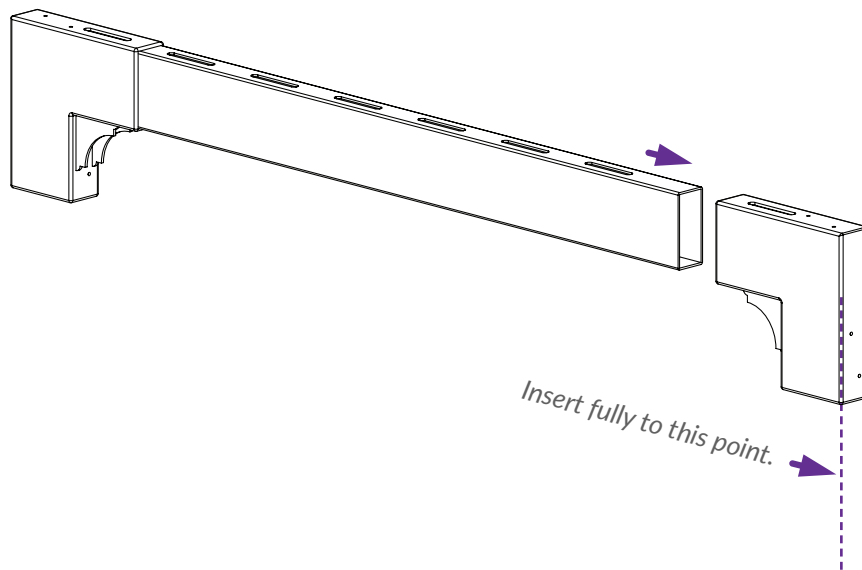

STEP 6 ▶

- ▶ Slide the top gate brackets and the top rail down over the vertical stiles.

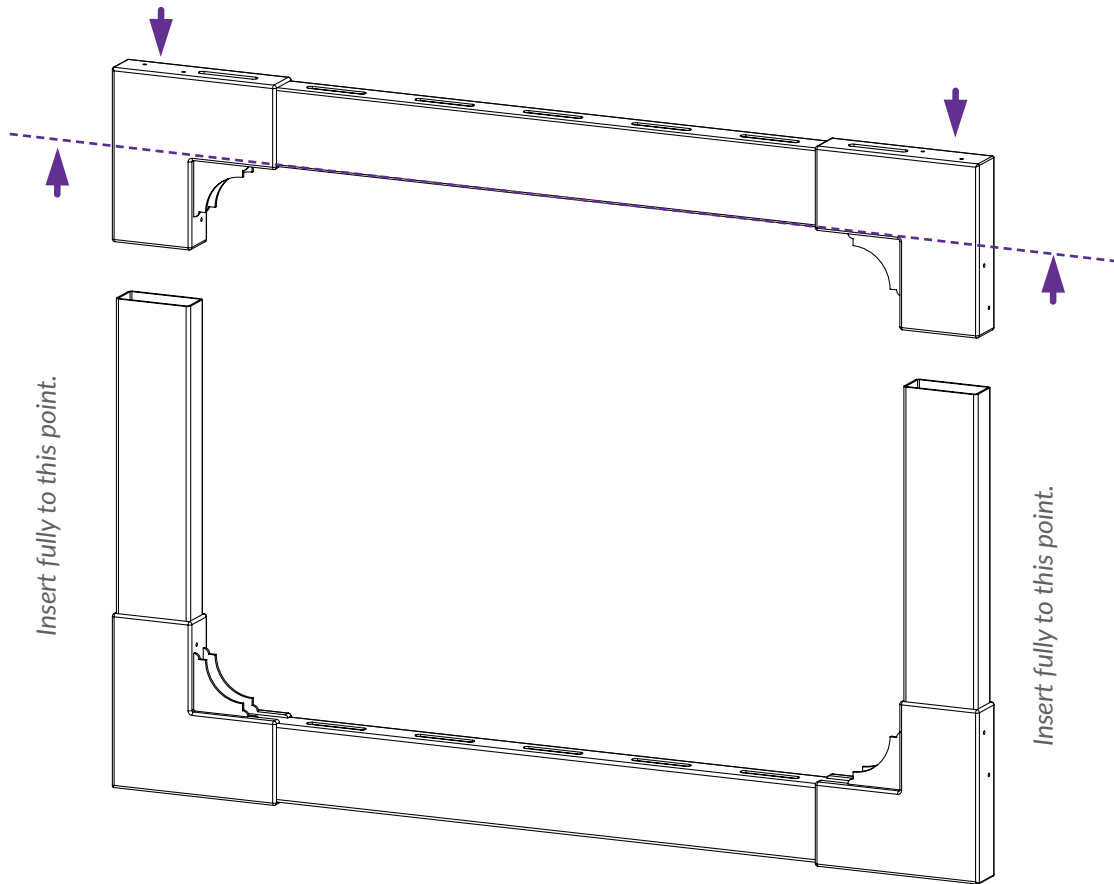

Assembled gate frame.

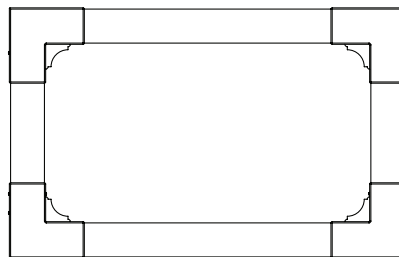

STEP 7 ▶

- ▶ Fasten the gate brackets to frame with (20) 1¼" White Self-Drilling Stainless Steel Screws **(G)**.

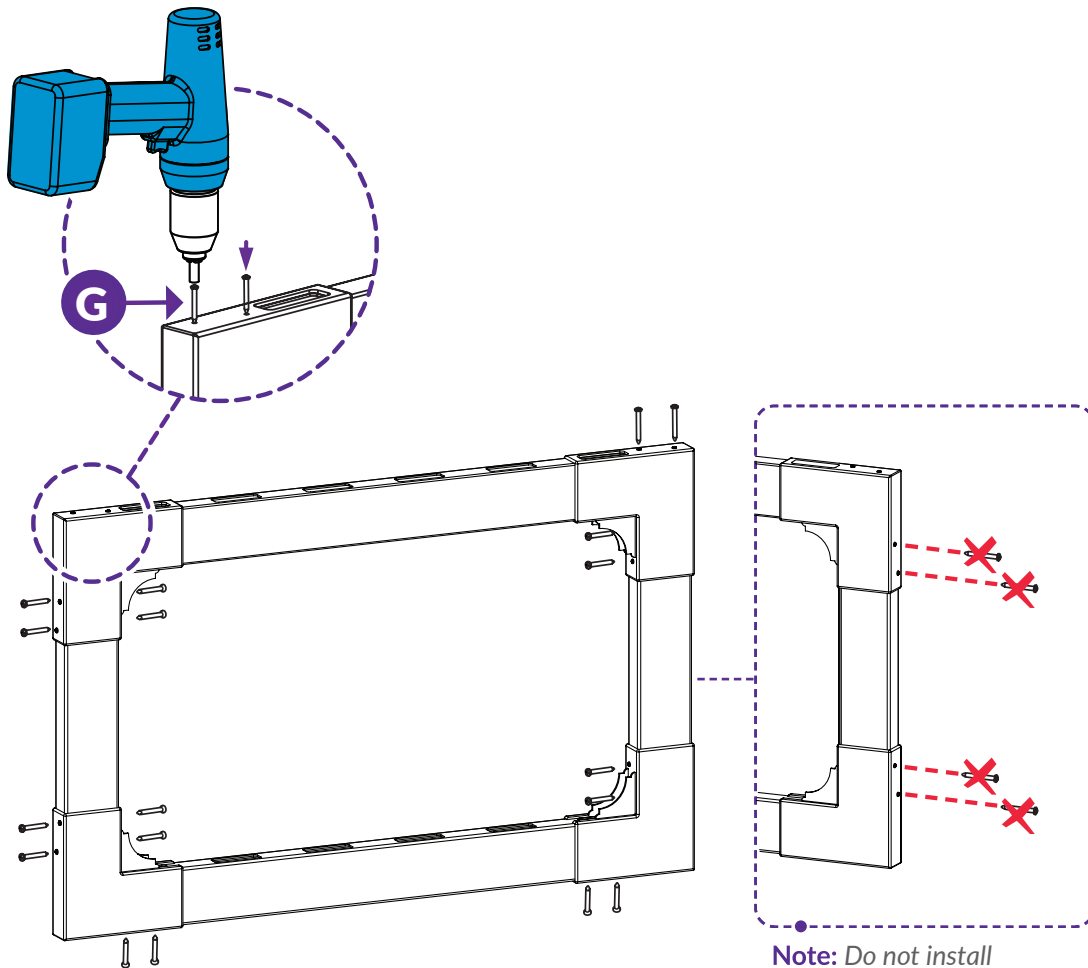

Note: Do not install outward screws on one side to allow for hinge installation.

INSERT PICKETS

STEP 8

► Insert Pickets (D) through the top rail down into the bottom rail in the pattern indicated.

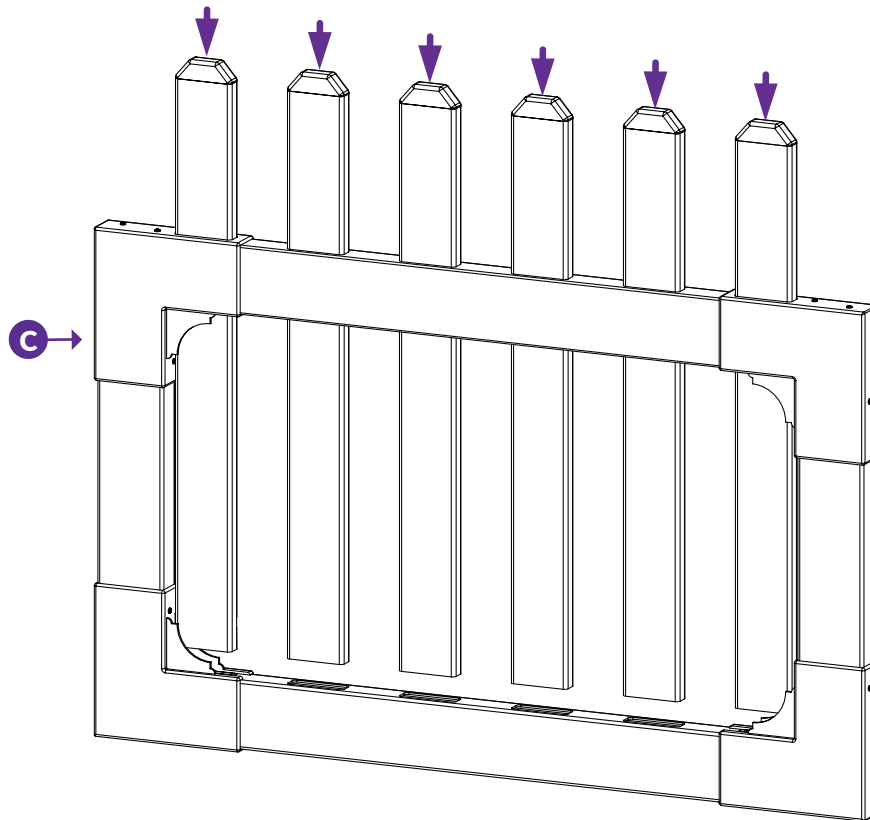

Completed gate with frame.

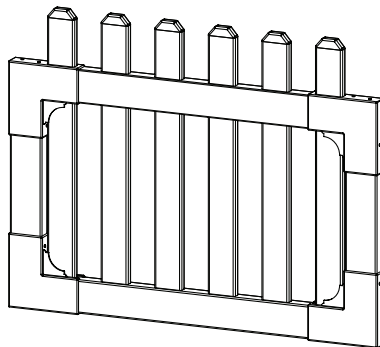

FASTEN HINGES

STEP 9

► Fasten the Hinges (**J**) onto the gate brackets with (8) 1¼" Black Self-Drilling Stainless Steel Screws (**H**).

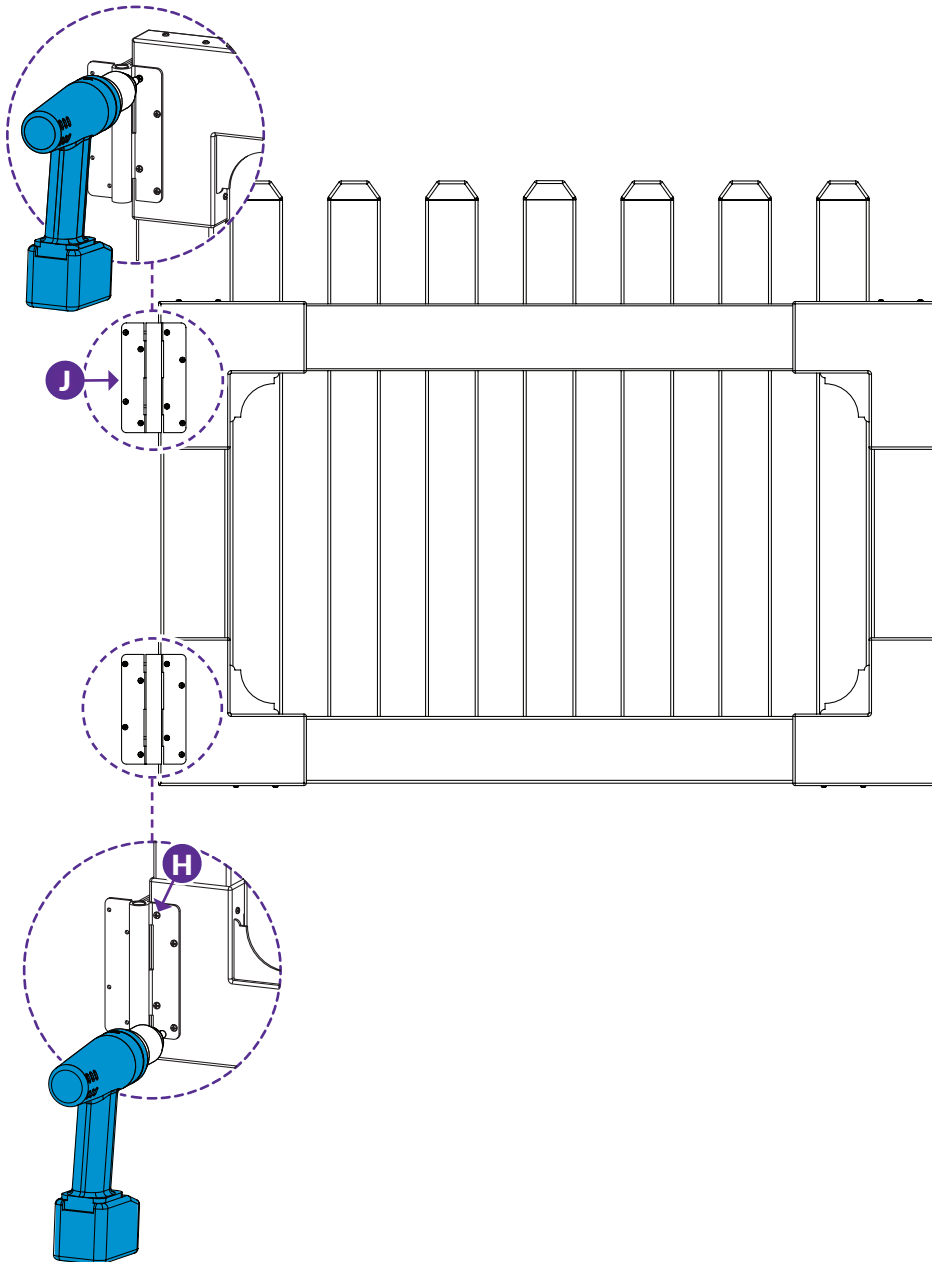

ATTACH HINGES TO FENCE POSTS

STEP 10

► Use temporary spacers or blocks to rest the gate on during installation.

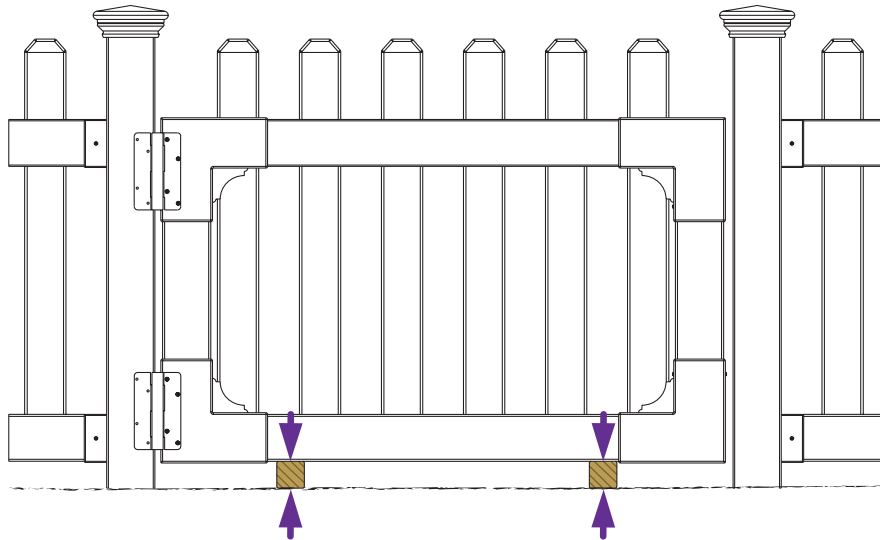

STEP 11

► Fasten Gate Hinges to the post with (8) 1¼" black self-drilling stainless steel screws.

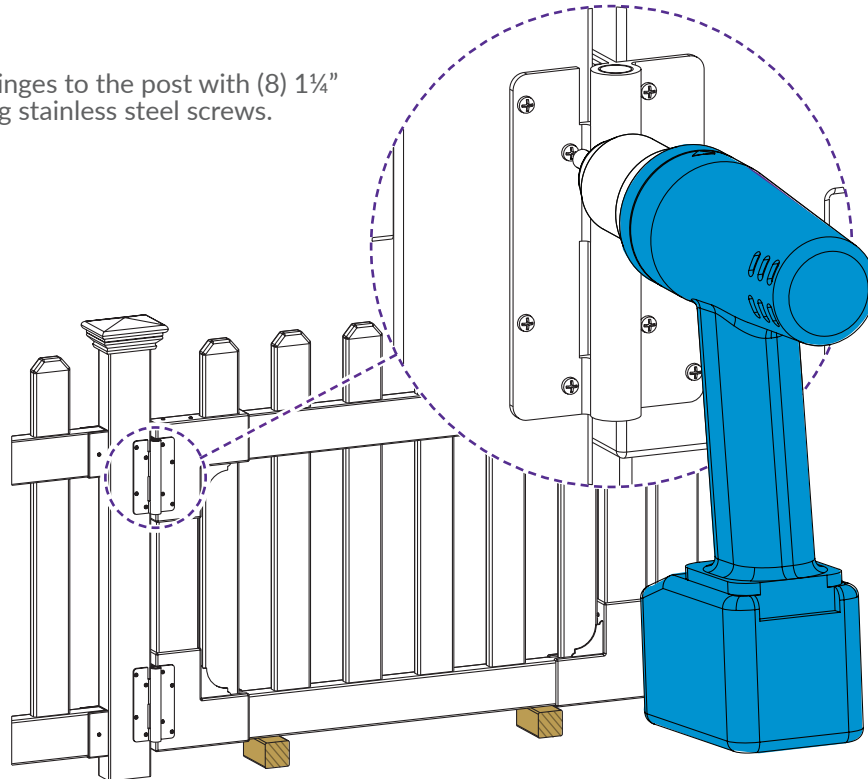

STEP 12 ▶

▶ Open the gate and fasten the hinges to the post from the inside with (16) 1¼" black self-drilling stainless steel screws.

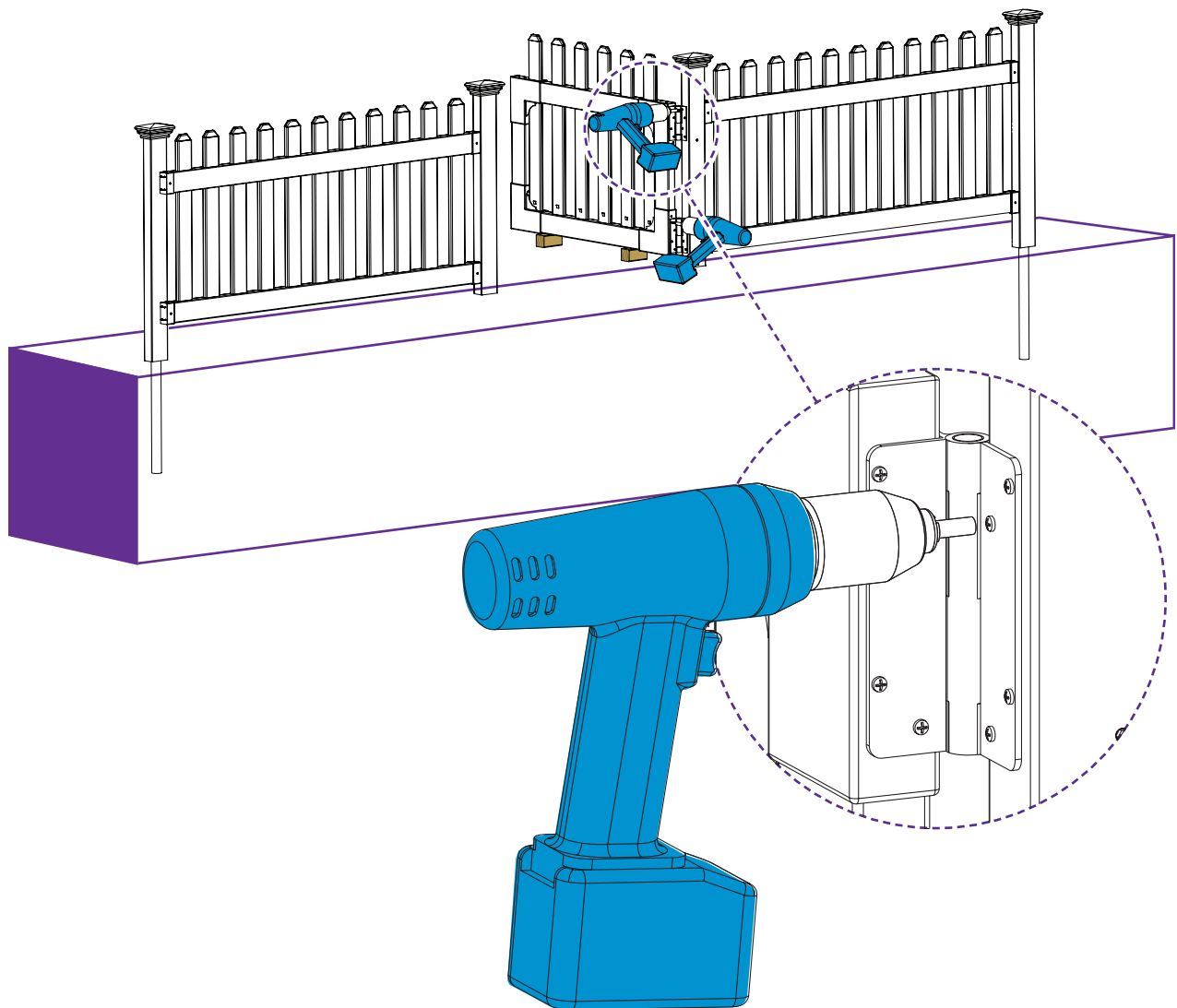

Note: If your internal pipe anchor ends up close to the inside corner of the post, you must angle your screws to avoid the pipe anchor. If the pipe anchor can't be avoided, pre-drill holes in the pipe anchor and install the gate with Black 1 ¼" Hex Head Screws (L). Do not attempt to drive the pan head screws into the pipe anchor.

INSTALL LATCH

STEP 13 ▶

▶ Align and fasten the Latch Catch (**L**) to fit and function with the Latch Finger (**K**) using the (6) 1¼" Black Self-Drilling Stainless Steel Screws (**H**).

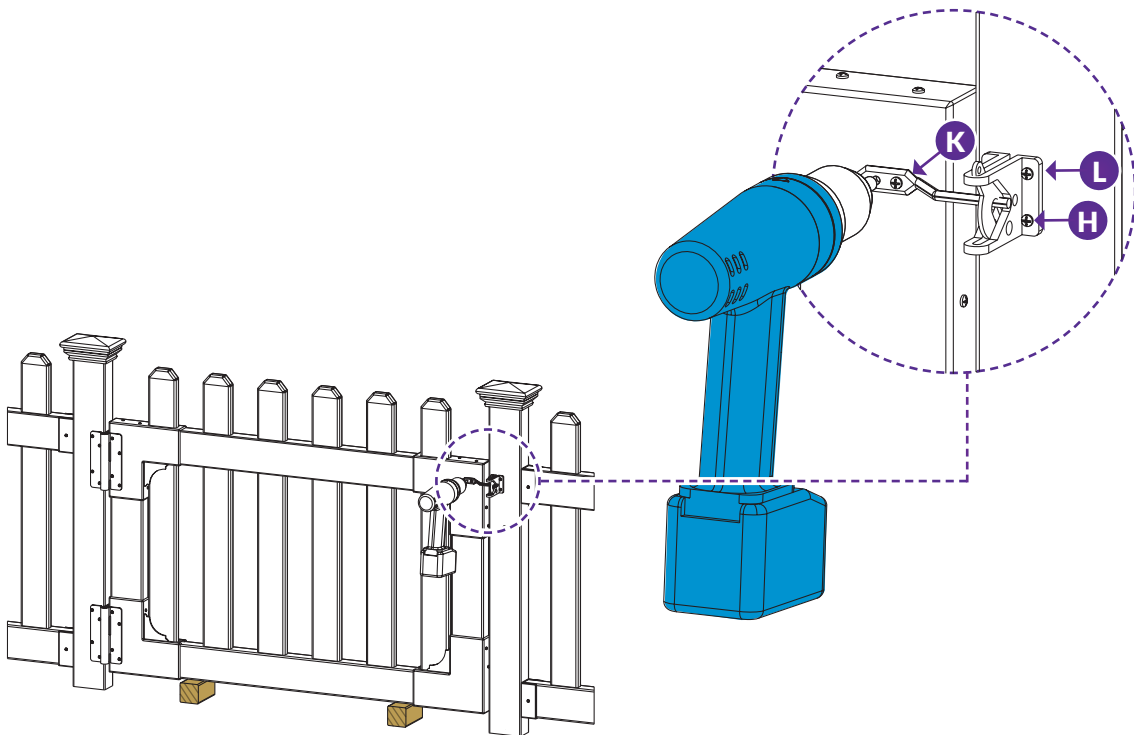



6935 Reames Rd. Ste. K.
Charlotte, NC 28216



hmmm@wambamfence.com

704-892-5222
877-778-5733



WWW.WAMBAMFENCE.COM